

## optibelt *ALPHA linear*

Optibelt ALPHA linear timing belting is employed as long length open-ended product predominantly in linear drive systems. The aramid or steel tension cord has extremely low elasticity. The flexible range of sections and lengths generate a host of drive solutions. The thermoplastic polyurethane surface is ideal for the application of various coatings and cams and lugs may be welded on.

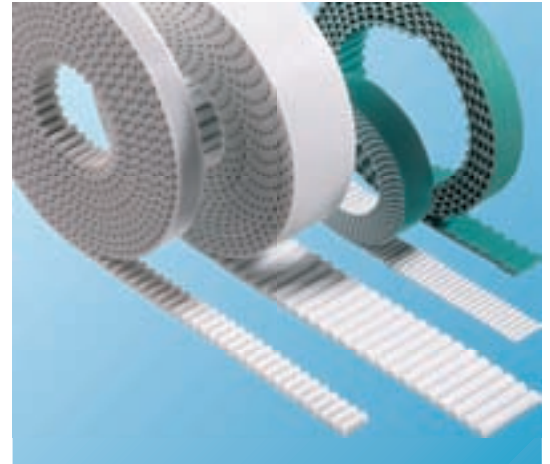

### Advantages

- Timing belts for linear and flexible drives
- Exact position precision
- Transmission of high tensile forces
- Ideal adjustment to transport or positioning conditions
- Variable length ranges, also lengths > 100 000 mm
- Available open-ended or joined endless
- Low maintenance
- Fabric coating on tooth face and/or belt back possible

The basic uses for Optibelt ALPHA linear are transport and conveying technology as well as handling and control engineering.

### *ALPHA linear*

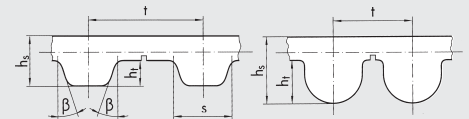

### *ALPHA linear D*

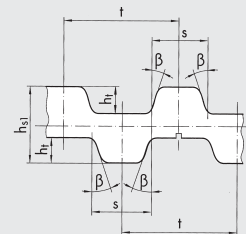

### Sections:

#### **ALPHA linear:**

XL; L; H; XH; 5M; 8M; 14M;  
T5; T10; T20; AT5; AT10; AT20  
double toothed on request

### Dimensions:

#### **ALPHA linear:**

joining endless from 600 mm  
other sizes on request

### Timing belt pulleys:

all standard pulleys  
special pulleys on request

## Examples of Applications

- |                             |                         |
|-----------------------------|-------------------------|
| Door and gate drive systems | ■ Linear drives         |
| Handling technology         | ■ Portal robots         |
| Machine tools               | ■ Carriage drives       |
| Washing plants              | ■ Fan control           |
| Conveyor belts              | ■ Stacking management   |
| Conveying technology        | ■ Synchronous conveyors |
| Medical technology          | ■ Sample transport      |
| Wood processing industry    | ■ Belt feed conveyors   |